

SZB IT Data Communication Cabinet 24 U, 600 x 600 mm

Catalogue number: W-IT-246060-45AA-2-161



PRODUCT DESCRIPTION

Cabinet for ICT applications based on a bolted frame.
Static load capacity: 1000 kg

Functionality

- 71 mm wide cable openings in the top and bottom plates allow to put thought the power cords with three-phase plug.
- Ventilation perforation in the top plate.
- All openings in the top and bottom plates blanked with knock-out blanking plates.
- U-marking on the mounting profiles.
- Maximum door opening angle: 270°
- Possibility to put the cabinet directly on the floor (no protruding elements under the cabinet).
- Adaptation for bying the cabinets in the rows.

CONFIGURATION

- Bolted frame (bottom plate, top plate, four posts).
- Single-leaf front door, perforated (80% perforation clearance) with a three-point lock with a handle.
- Double-leaf rear door, perforated (80% perforation clearance) with a three-point lock with a handle.
- Two solid metal side panels with single-point locks.
- Two pairs of 19" mounting profiles, type STANDARD.
- Earthing bar.
- Earthing cables for doors and side panels (not shown in the photos).
- Four levelling feet.

TECHNICAL DATA

Material

Sheet steel.

Protection degree

IP 20 in accordance with EN 60529.

Surface finishing

Frame, side panels, doors – powder paint, black (RAL 9005).
Mounting profiles, C-profiles – zinc coated.



SZB IT Data Communication Cabinet 24 U, 600 x 600 mm

Catalogue number: W-IT-246060-45AA-2-161



A-A section

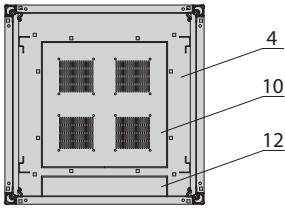

Front view

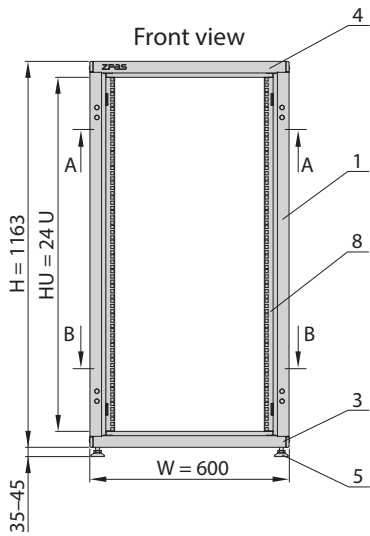

Side view

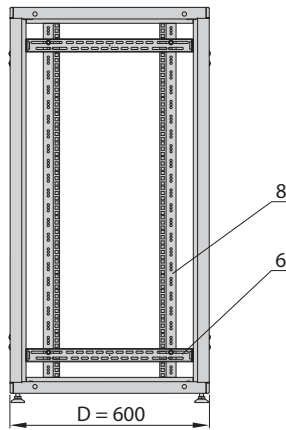

DESIGN

- 1. Frame's post
- 3. Frame's bottom plate
- 4. Frame's top plate
- 5. Adjustable feet
- 6. C-profile for 15 mm deep mounting profiles
- 8. 19" mounting profile, type STANDARD, 15 mm deep
- 9. Earthing bar
- 10. Knock-out blanking plate 380 x 380 mm
- 12. Knock-out blanking plate 380 x 71 mm

Note:

The cabinet in the drawing is shown without any panels or doors.

B-B section

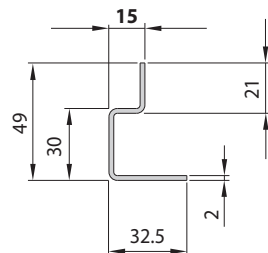
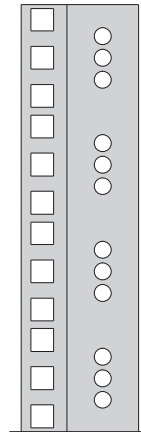
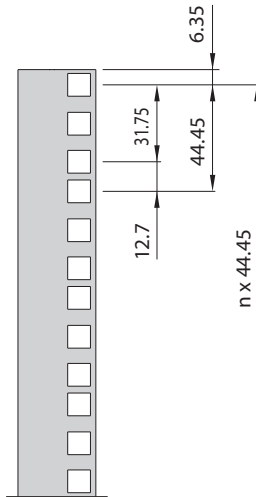
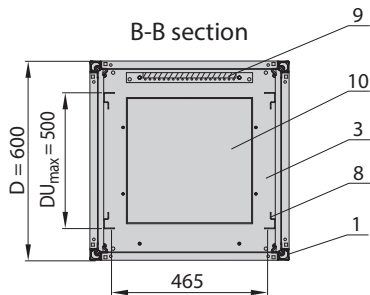

19" mounting profile
type STANDARD
15 mm deep